

East Elevation

11
A10
3/16" = 1'-0"

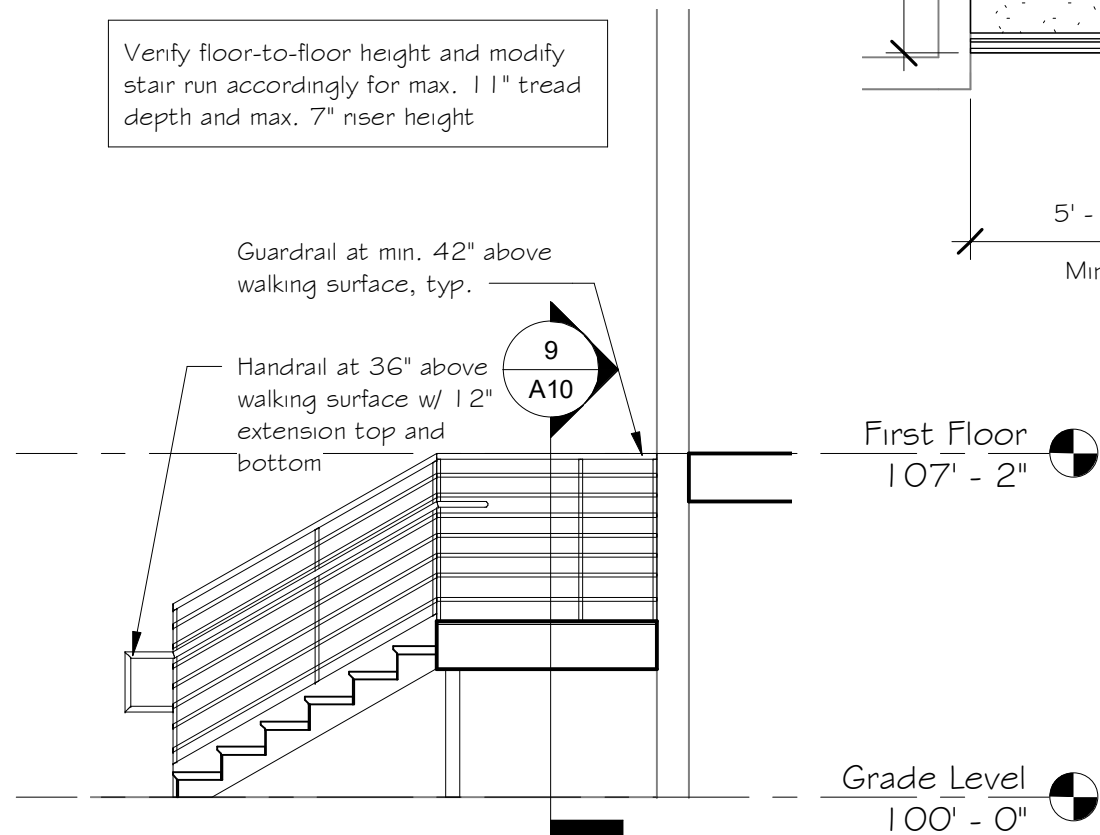

Stair Section 3

10
A10
1/4" = 1'-0"

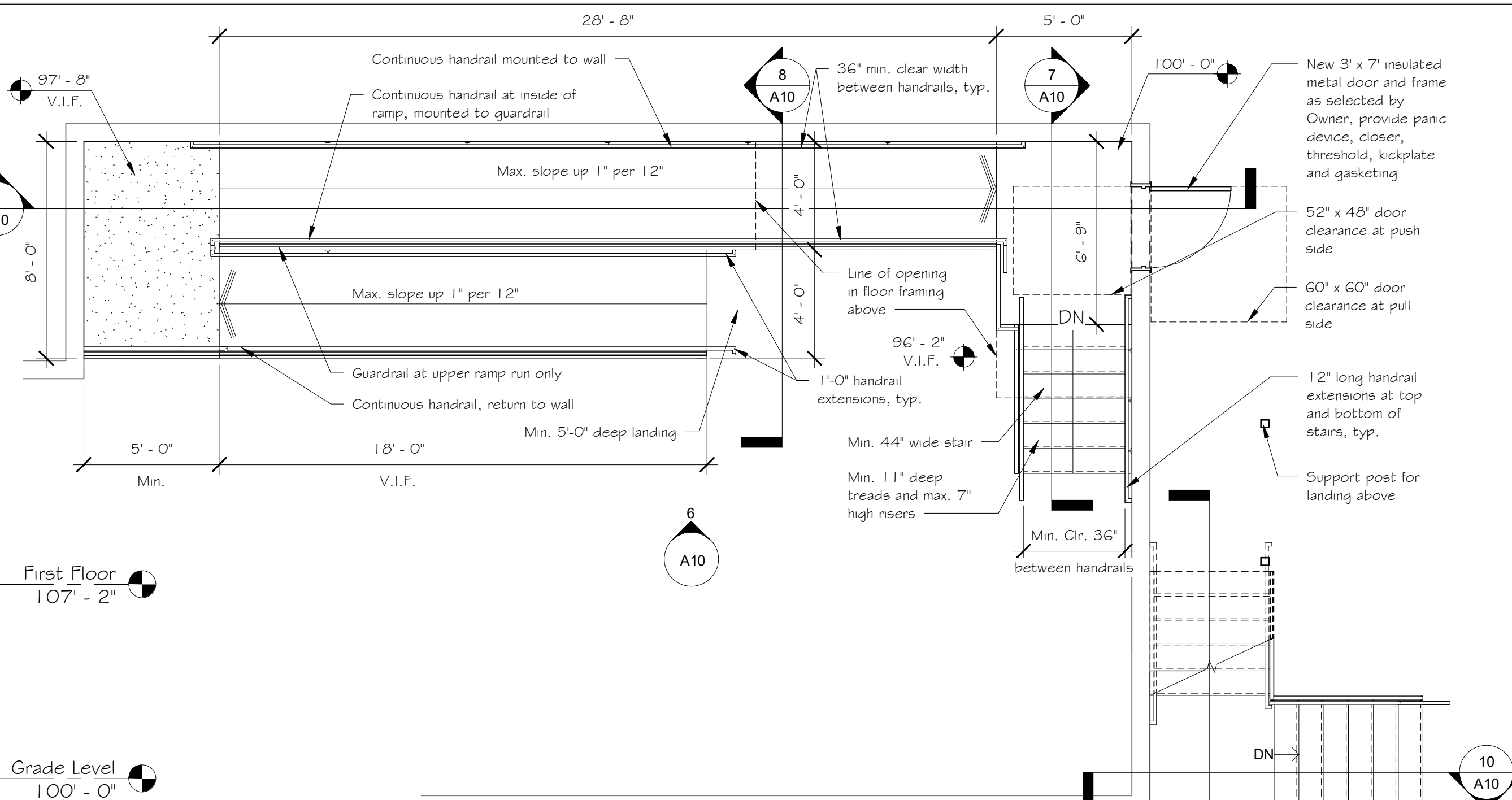

Grade Level Plan

2
A10
1/4" = 1'-0"

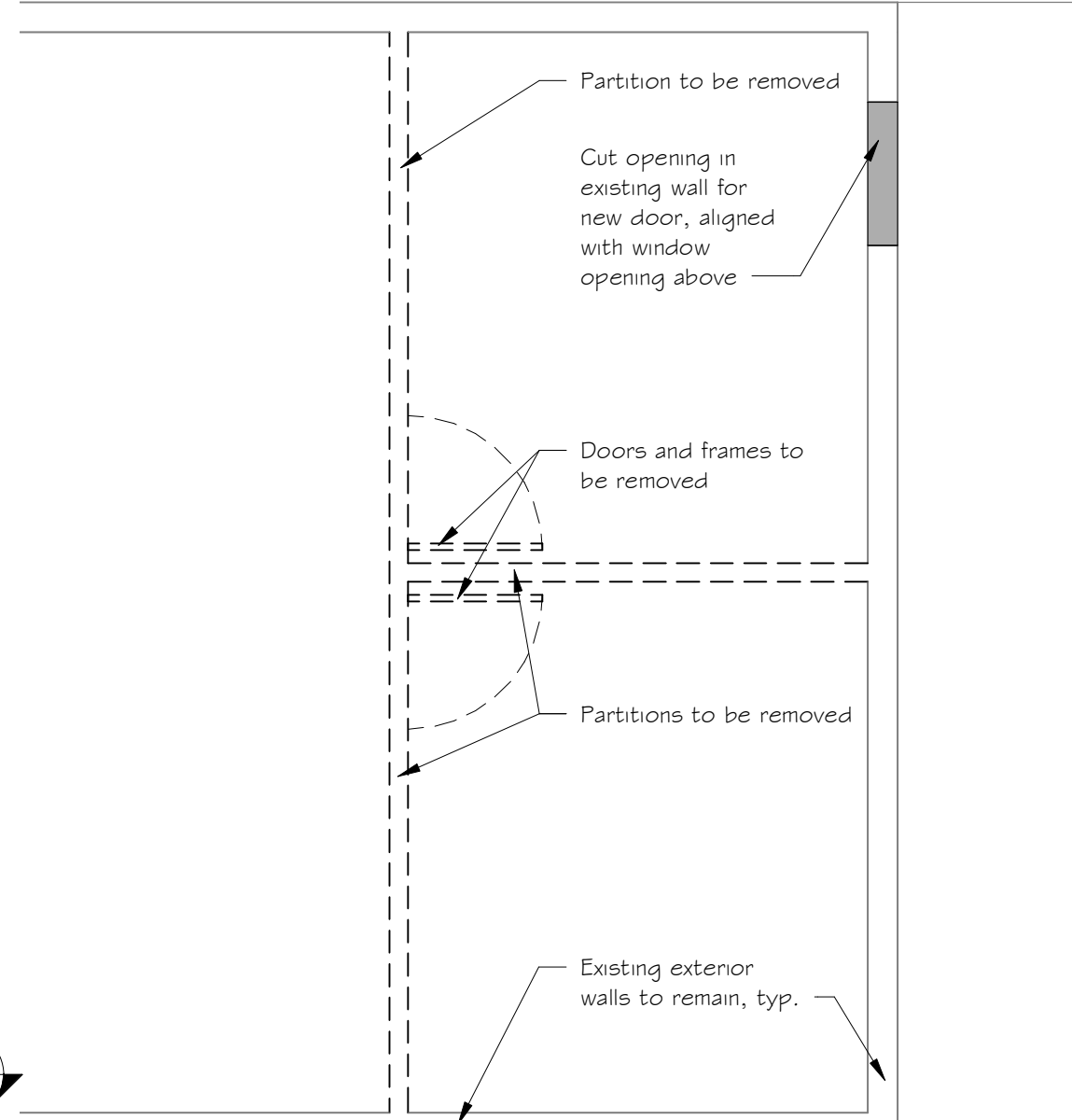

Grade Level Demo Plan

1
A10
1/4" = 1'-0"

- General Stair Notes:
- Provide guardrails min. 42" above walking surface at stairs and landing, typ. Construct railing with intermediate rails, either painted pipe steel or cables, spaced to prohibit a 4" sphere from passing through. Mount vertical support posts to stringer or landing beams. Guardrail assembly shall be constructed to withstand 200# lateral force.
 - Provide handrails at both sides of stairs. Handrails shall be 1 1/2" diameter painted steel or wood, mounted to either wall surface or guardrail. Locate handrails 36" above walking surface with 12" extensions at top and bottom, except where continuous at inside of stairs. Return ends to within 1/2" of wall or guardrail.

- General Grade Level Notes:
- Provide guardrails min. 42" above walking surface at Grade Level landing, upper ramp run and open sides of stairs and landings. Construct railing with intermediate rails, either painted pipe steel or cables, spaced to prohibit a 4" sphere from passing through. Mount vertical support posts to either stair treads, ramp curb or landing floor slab. Guardrail assembly shall be constructed to withstand 200# lateral force.
 - Provide handrails at both sides of ramps and stairs. Handrails shall be 1 1/2" diameter painted steel or wood, mounted to either wall surface or guardrail. Locate handrails 36" above walking surface with 12" extensions at top and bottom, except where continuous at inside of ramp run or stairs. Return ends to within 1/2" of wall or guardrail.

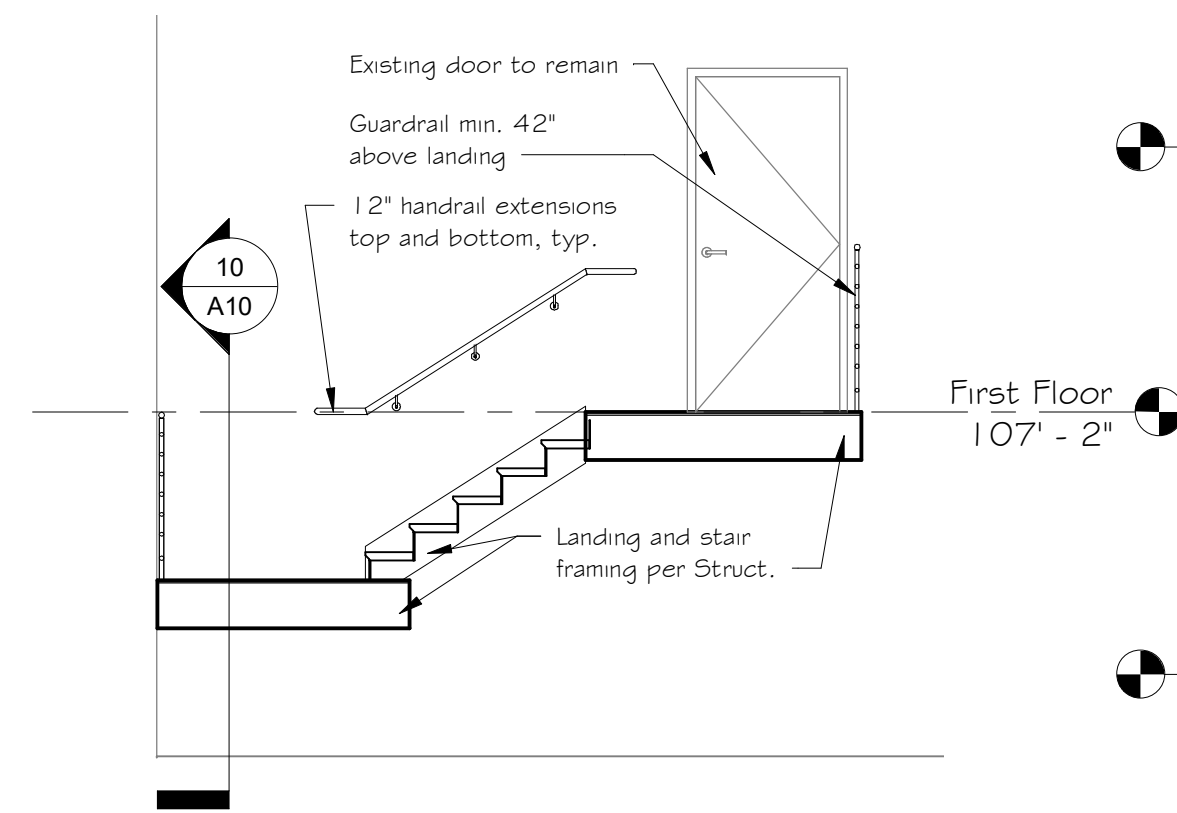

Stair Section 2

9
A10
1/4" = 1'-0"

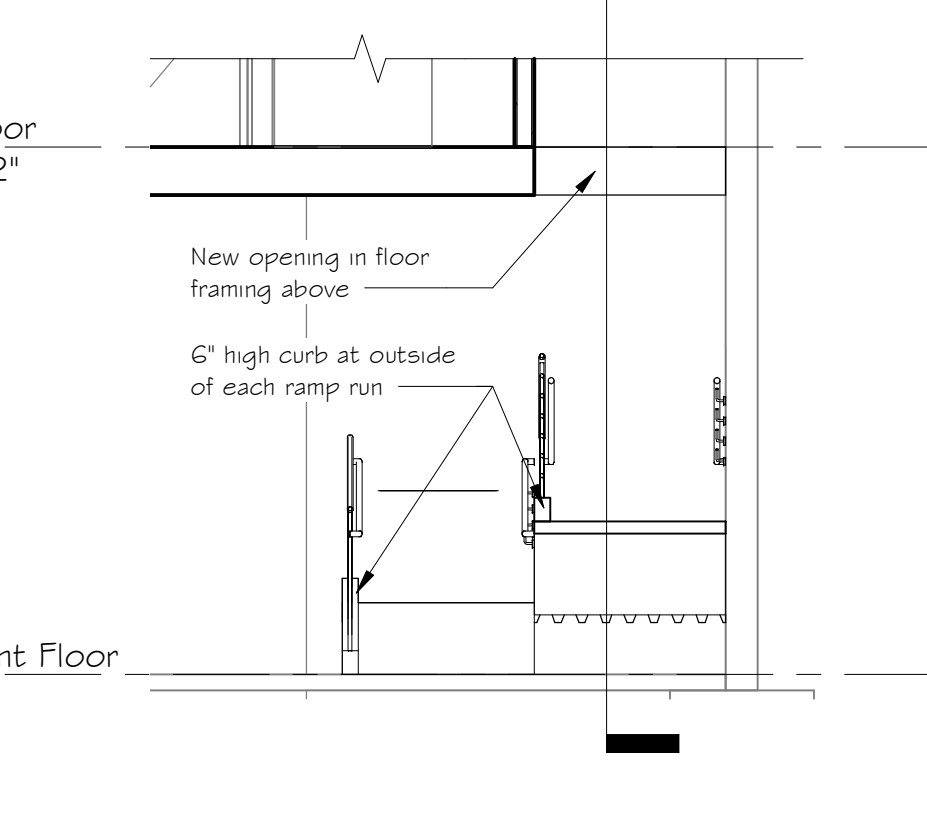

Ramp Section 2

8
A10
1/4" = 1'-0"

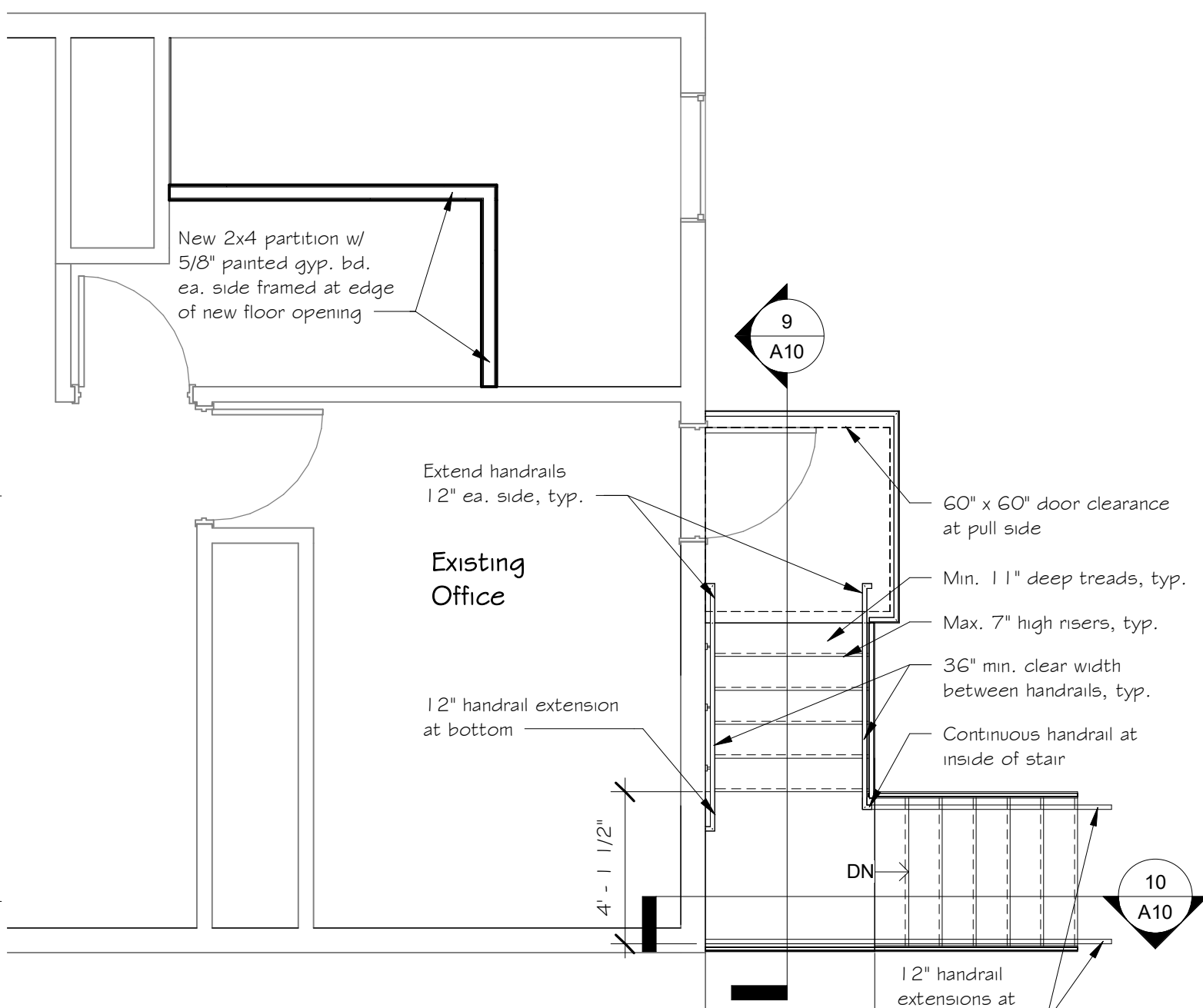

First Floor Plan

4
A10
1/4" = 1'-0"

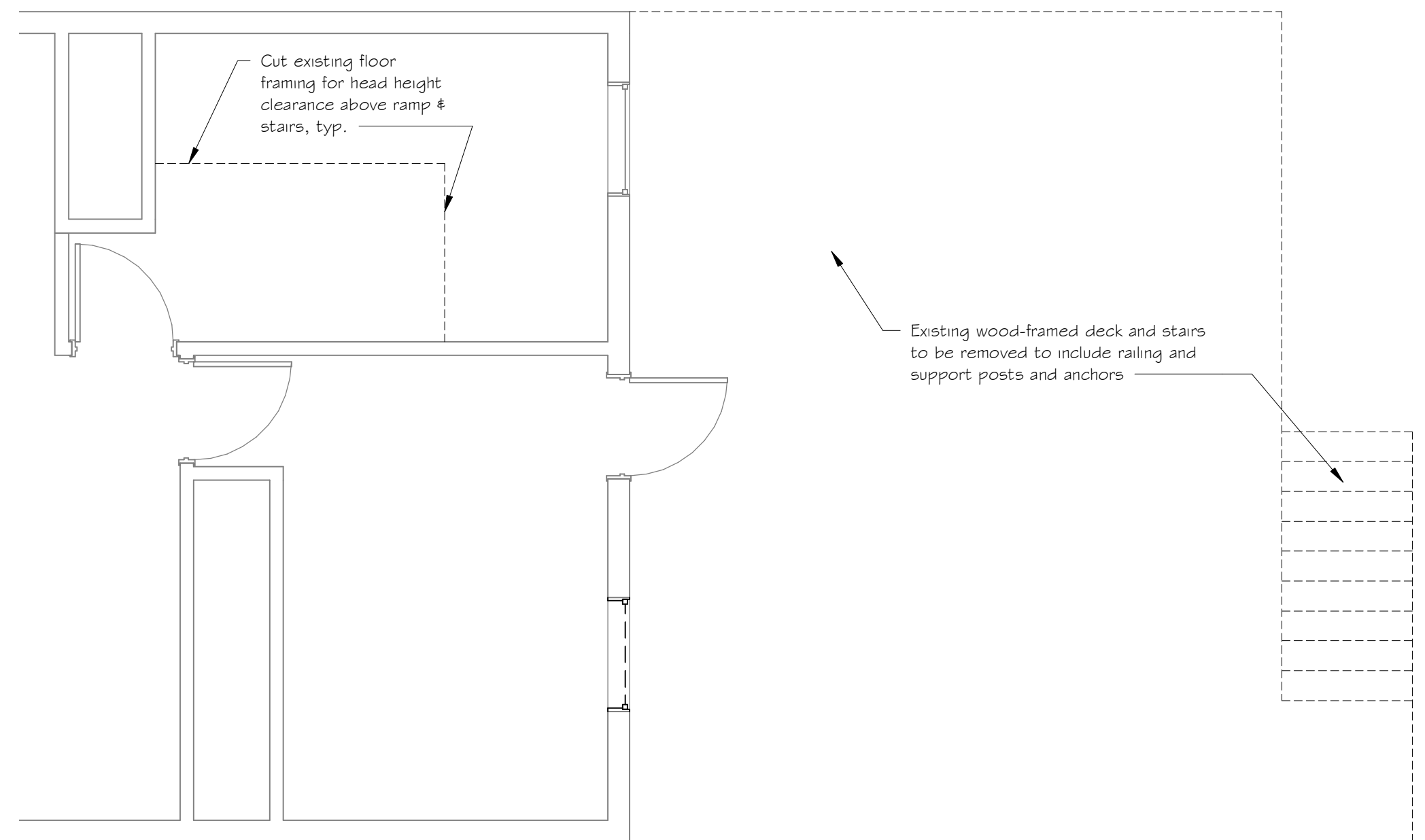

First Floor Demo Plan

3
A10
1/4" = 1'-0"

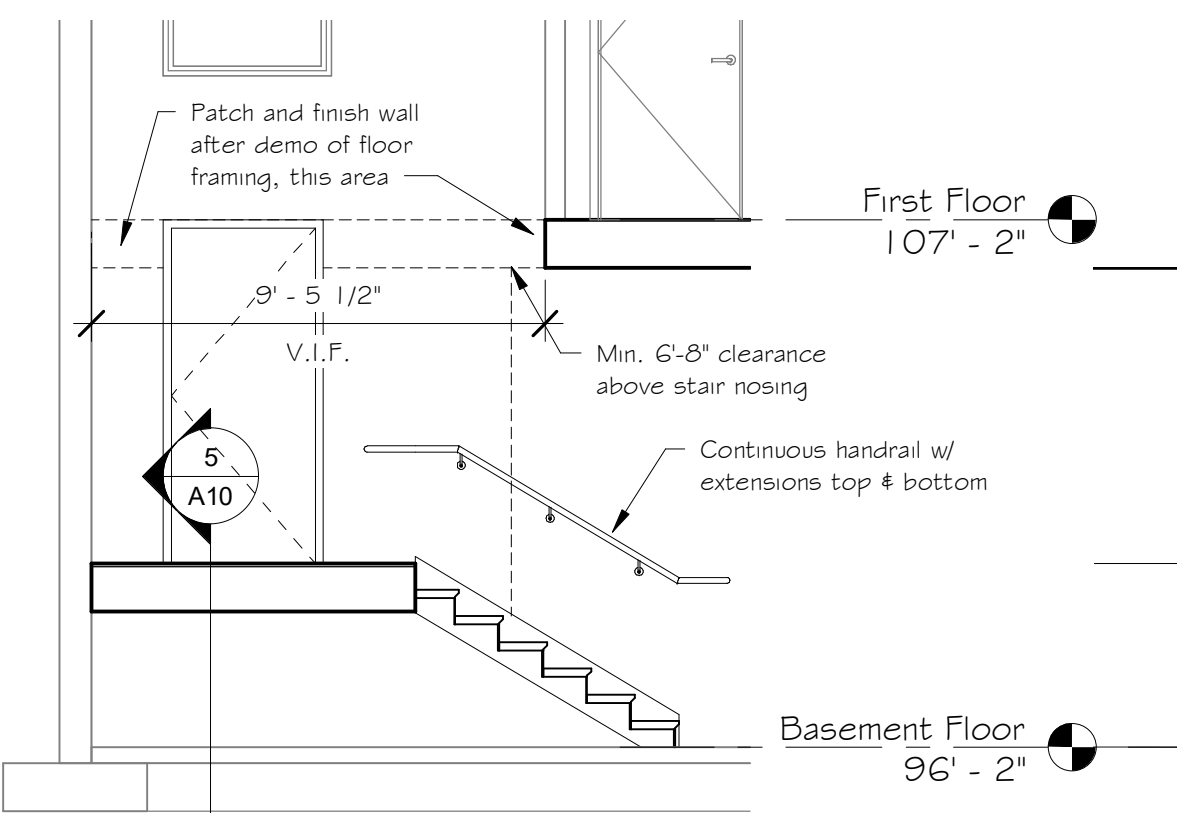

Stair Section 1

7
A10
1/4" = 1'-0"

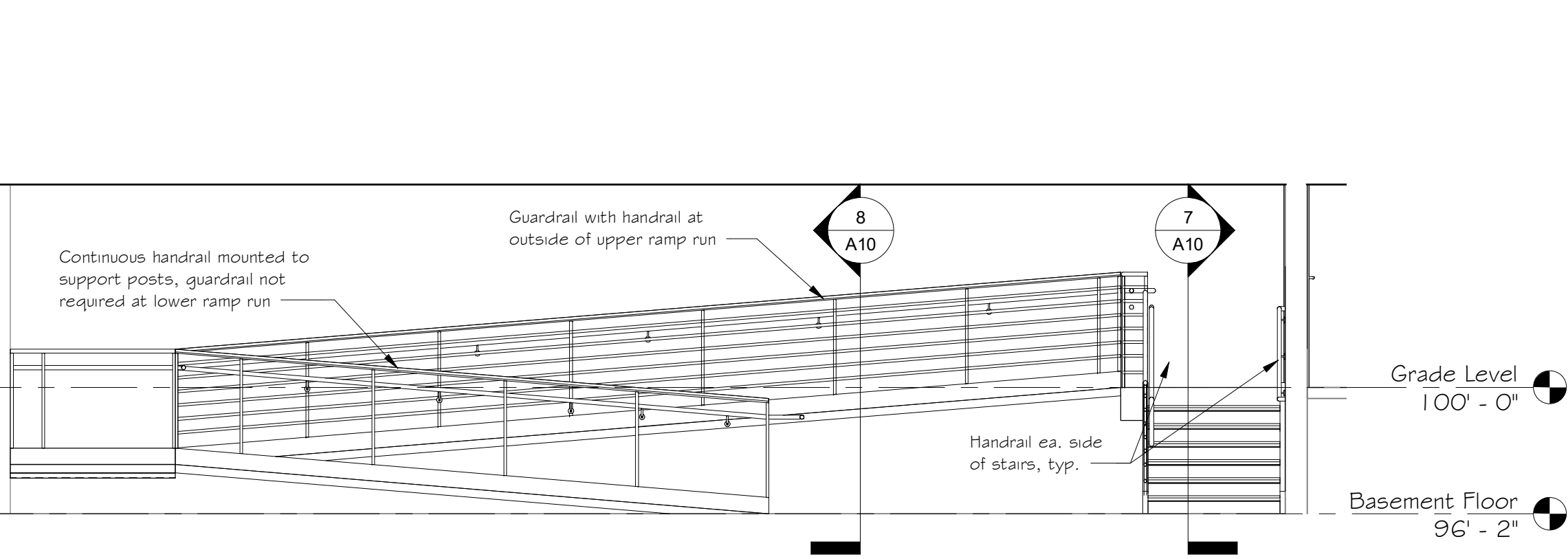

Ramp Elevation

6
A10
1/4" = 1'-0"

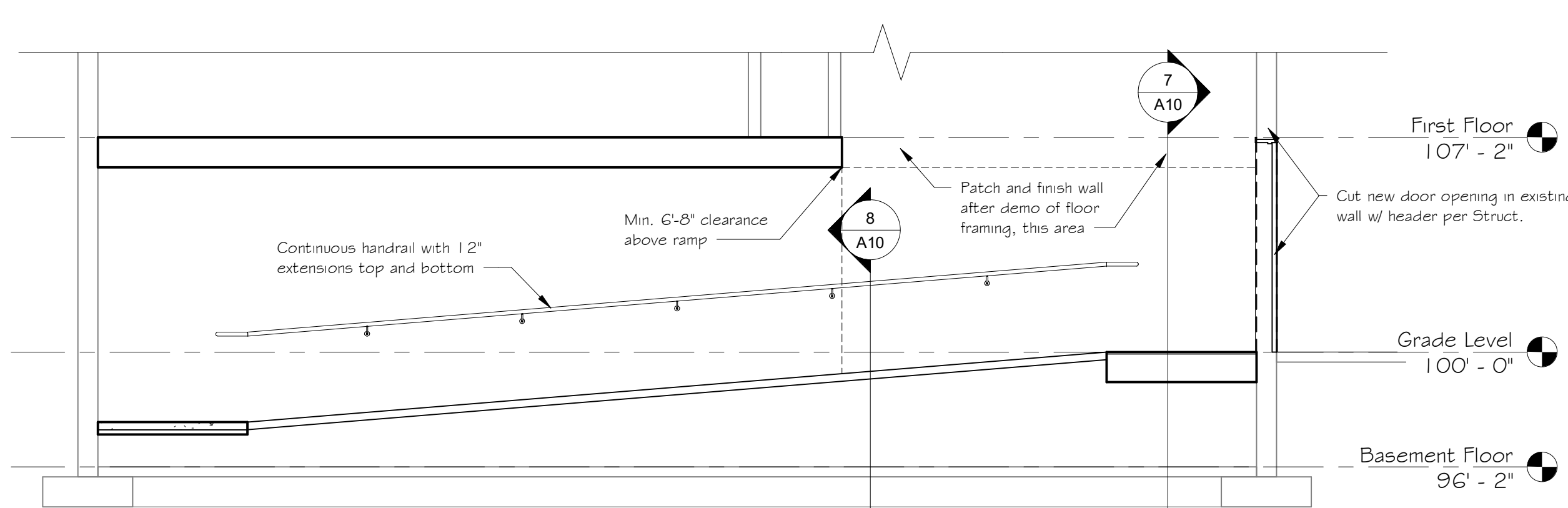

Ramp Section 1

5
A10
1/4" = 1'-0"

© 2020 HALCYON DESIGN LLC EXPRESSLY RESERVES ITS COMMON LAW COPYRIGHT AND OTHER PROPERTY RIGHTS IN THESE PLANS. THESE PLANS ARE NOT TO BE REPRODUCED, CHANGED OR COPIED IN ANY FORM OR MANNER WHATSOEVER, NOR ARE THEY TO BE ASSIGNED TO ANY THIRD PARTY WITHOUT FIRST OBTAINING THE EXPRESSED WRITTEN PERMISSION AND CONSENT OF HALCYON DESIGN LLC.

ALL CONSTRUCTION SHALL CONFORM TO CURRENT INTERNATIONAL BUILDING CODE AND ALL OTHER APPLICABLE CODES.

DO NOT SCALE DRAWINGS FOR DIMENSIONS.

Accessibility Upgrade

698 Briggs St.
Erie, CO

Halcyon Design LLC

PO Box 30
Frederick, CO 80530
303.906.2617

DATE
1.30.20

REVISIONS

SHEET TITLE
Basement Ramp Dtls

SHEET NUMBER
A10

Project No. 1946