

September 28, 2017

Ms. Wendi Palmer
The Town of Erie
P.O. Box 750
Erie, CO 80516-0750

Re: WO# 201709035 – Reuse Pump Station

Dear Ms. Palmer:

United Power (United) has completed the design and cost estimate to provide electric service for the reuse pump station, located at 3230 County Rd 5. (See the attached design.)

The net construction deposit required to install the electric service is \$30,420.98. That cost includes the labor, material, administrative and general expense required to install the electric service as designed. The estimate is valid for ninety (90) days, per Tariff E-004, on file with the Colorado Public Utilities Commission or available upon request.

In accordance with United's Tariff E-007, on file with the Colorado Public Utilities Commission or available upon request, United will analyze the final cost and compare it to the estimate when the work order is closed. If the actual cost is less than originally estimated, United shall refund the difference to the Applicant. If the actual cost to United proves to have been greater than the construction deposit, Applicant shall pay the difference to United within thirty (30) days following written notice of such excess amount.

Please complete the enclosed private utilities form (excluding subdivision developments and overhead projects), indicating any private utilities in the project area. You may return the signed and completed form and your payment in the envelope provided. Payment in full is required prior to construction. **Subdivision developers must return the signed final design for the underground distribution and the streetlight design, if applicable.**

Payment of the invoice implies agreement with the terms stated below:

- Applicant grants to United the right to enter the location listed above to construct, operate and maintain the electric distribution facilities, together with full right of ingress and egress.
- Applicant shall perform all right-of-way clearing required for the construction of the facilities described above with United's specifications.
- United shall perform all trenching and backfilling, including any rock removal and backhoe work, in accordance with United's specifications, except street crossing.
- The Applicant shall establish and stake all easements of rights-of-way on land owned by the Applicant for installation of United's facilities. The Applicant shall assume all responsibility for proper location thereof and shall reimburse United for any expense due to subsequent changes and for any damage claims against United, including full reimbursement for damages established and expenses incurred in regard thereto, plus reasonable attorney's fees and court costs.
- United shall install the facilities described herein in accordance with good engineering practice after the Applicant has established said right-of-way, cut easements to final grade, and prior to the paving

of any streets and the construction of any curbs and gutters. The Applicant shall reimburse United for any expense due to subsequent changes by the Applicant.

- The Applicant shall be responsible for coordinating all construction activities within the project, including, but not limited to, the installation of telephone, gas, and cable TV. The installation crew must be on site the day United digs the trench. United will not leave the trench open overnight and will close it at the end of each working day. The Applicant shall reimburse United for any expenses incurred by United to repair damages to its facilities caused by the Applicant or other parties during the construction period
- Applicant will be responsible for accurately locating and visibly marking all private underground utilities, (including but not limited to water, telephone, sewer, septic, cable TV, fiber, and gas) prior to the construction of any facilities by United. Any damages to unmarked underground utilities by United or United's contractors will be at the Applicant's expense and responsibility to repair.
- Applicant shall be responsible for all service laterals in residential subdivision and underground commercial/industrial services. See approved service lateral contractor list on our web site at www.unitedpower.com under the New Construction tab and click on the hyperlink for Metering/Laterals/Inspections, or call the construction hotline at 303-637-1323.
- Electric service will be provided to Applicant at United's applicable rates and upon the terms and conditions now in effect or at the rates and upon such terms and conditions as may hereafter be lawfully adopted by United for such service.
- United reserves the right to revise said estimate and to require an increase in the non-refundable construction deposit from the Applicant to cover unexpected costs to install its facilities. Such costs will be described on a **change order** and billed per incident according to the time, equipment, and materials used. If the Applicant requires construction of the facilities when the ground is frozen or at a time when inclement weather will result in construction costs greater than the cost originally estimated, the applicant shall advance the estimated additional cost to United, as a contribution in aid of construction, prior to the construction of the facilities.
- United will be responsible for locating all public utilities through Colorado 811.
- Applicant may terminate this project at any time prior to or during the actual construction of electric facilities. In such an event, a portion or all of the consideration paid by the Applicant in advance to United hereunder shall be used to reimburse and pay United for all expenses or liabilities which may theretofore have been incurred by United for engineering, for materials, and equipment purchased or ordered, prior to the date of termination; with the balance of the construction deposit, if any, to be refunded to the Applicant.

Thank you for the opportunity to provide this service. If you have questions, please call me at 720-685-5608.

Sincerely,



Andy Ross
Project Coordinator II

ADR:hkh

Enclosures

INVOICE

Work Order: **201709035**
Service Order: **2017037651**
Project Name:
Description: **REUSE PUMP**

TOWN OF ERIE
PO BOX 750
...
ERIE, CO
80516

Estimated Construction Costs:	\$	27,120.98
Plant Investment Holding:	\$	1,800.00
CT Metering:	\$	1,500.00
NET CONSTRUCTION DEPOSIT INVOICE:	\$	30,420.98

The estimate is valid for ninety (90) days, per Tariff E-004, on file with the Colorado Public Utilities Commission or available upon request.

UNITED POWER WILL NOT ACCEPT ANY CHECK WITH LIEN WAIVER LANGUAGE



Coordinator: **ANDREW ROSS**

Date:

Coord. Ph: **720-685-5608**

QC/Review:

Review Date:

Designed By: **Bryce Lanckriet**

Date:

Designer Ph: **970-571-3581**

Peer Review:

Date:

Revised By:

Date:

Revision #:

Assigned By:

Assigned Date:

Sub/Circuit/Phase: **34-4**

ABC

ROW Easement Req: ☒

Fusing Req'd: ☐

Locates UPI Req'd: ☐

Locates Cont Req'd: ☐

Work Order: **201709035**

Service Order: **2017037651**

Project Name:

Description: **REUSE PUMP**

Equipment Loc:

Service Loc: **4416**

Account :

Home Ph: **303- 926-2700**

Daytime Ph:

Customer: **TOWN OF ERIE**

Svc Address: **3230 COUNTY RD 5**

City: **ERIE**

County: **WELD**

Sec/Twn/Rng: **17 1N 68W**

Conductor Summary

Conductor Size	Status	Placement	Type	# Wires	Span (Ft)	Total
UP 1/0 EPR C	New	UG	PRIMARY	3	435	1395

COMMENTS

Project Notes

Inspection By:

Date:

Construction By:

Date:

COVERSHEET

9/28/2017

Page 1 of 1

VICINITY MAP

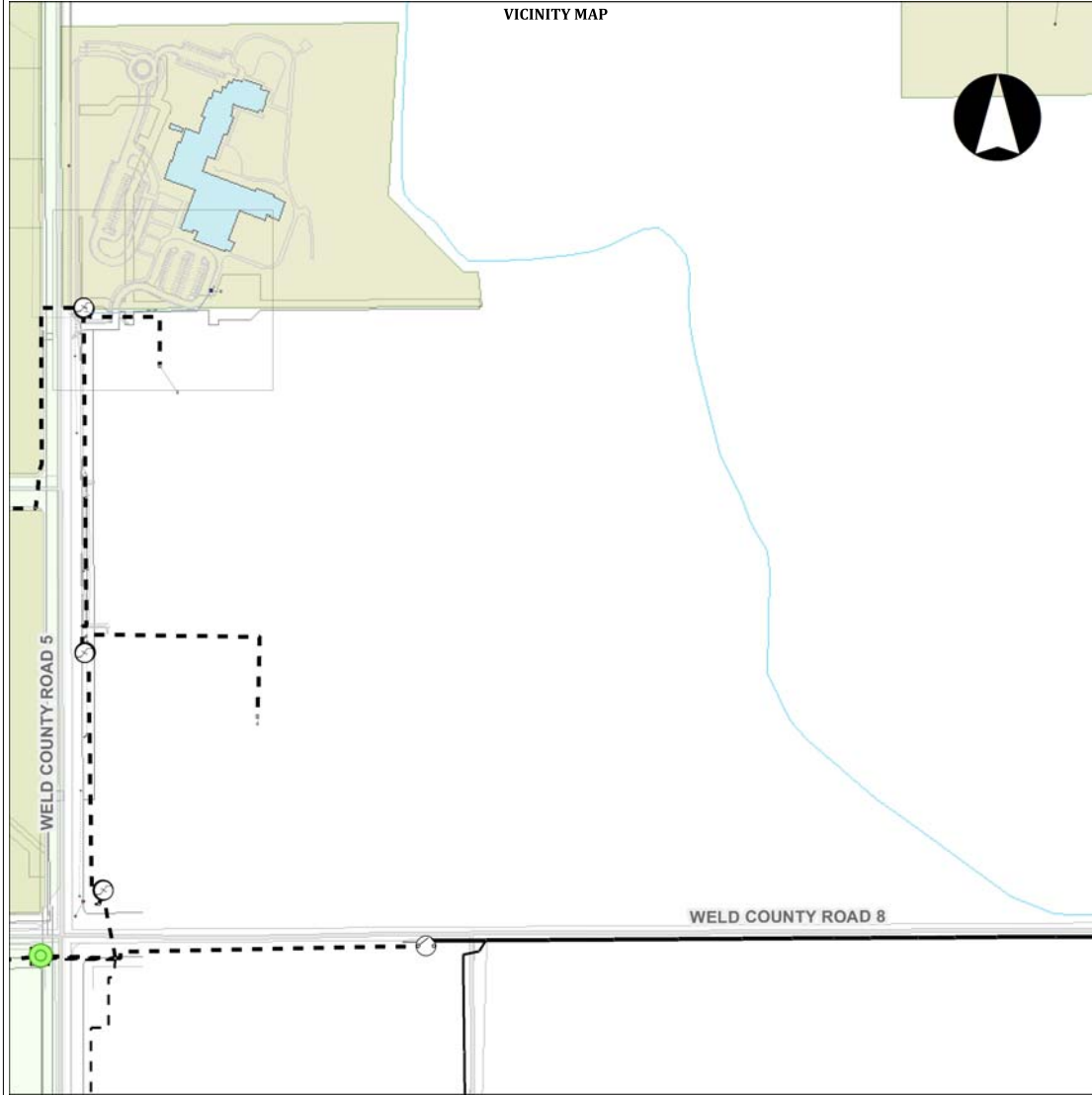



Work Order: 201709035
Service Order: 2017037651
Project Name:
Description: REUSE PUMP
Service Loc: 4416
Customer: TOWN OF ERIE
Svc Address: 3230 COUNTY RD 5
City: ERIE
County: WELD

ROW Easement: ☒
Fusing Req'd: ☐
UPI Loc. Req: ☐
Cont. Loc Req: ☐

Coordinator: ANDREW ROSS
Cell: 720-685-5608 Date:
Designer: Bryce Lanckriet
Cell: 970-571-3581 Date:

Comments

Project Notes

Legend

